

TOOLS REQUIRED:

- Tape Measure or Ruler
- Marker
- Centre Punch
- Power Drill
- 5mm Drill Bit
- Suited Rivet Gun
- Eye Protection

SABER ROPE TRACK INSTALLATION



STEP 1

- Using a tape measure / ruler mark and centre punch the sections 15mm from either side.
- Mark and centre punch centre of section at 200 mm.

(Tip: the section face will have three distinctive grooves along the profile - to assist in aligning holes to be drilled mark on the centre groove)



STEP 2

- Secure the section adequately.
- Ensure you are wearing eye protection .
- Using a 5 mm drill bit carefully drill all three marks on both sections.
- Carefully drill all three marked holes .
- (Ensure drill bit does not protrude further than 30 mm)



STEP 3

- Your bracket should look like this with three drilled holes marked at 15mm each side and central at 200mm.

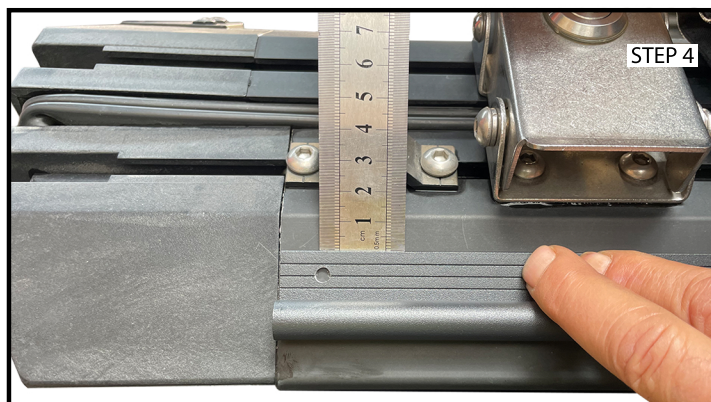

STEP 4

- At the main rear entry of tent align the edge of the section where corner of tent profile meets aluminium base profile (see pic)
- Measure approx 12 mm down on the front edge of the tent profile seam (see pic)
- Mark transfer and centre punch all three holes to tent to profile.



STEP 5

- Using rivet gun insert and fix provided rivets

